



Engineered Honeycomb
Solutions and Services

Plascore Micro

Modular Cleanroom Systems



PLASCORE[®]
MODULAR CLEANROOMS



PLASCORE[®]
MODULAR CLEANROOMS



At Plascore, we are committed to providing a high-quality product paired with engineered solutions for a wide variety of applications. We are a global manufacturer of honeycomb panels, which are a high-strength, lightweight material for use in the Cleanroom Industry. Plascore has developed innovative cleanroom wall systems to meet the needs of numerous construction specifications. Our experienced and dedicated cleanroom staff can also develop custom solutions for any architectural condition. We are capable of handling any size project including design, production, and delivery of materials on schedule.

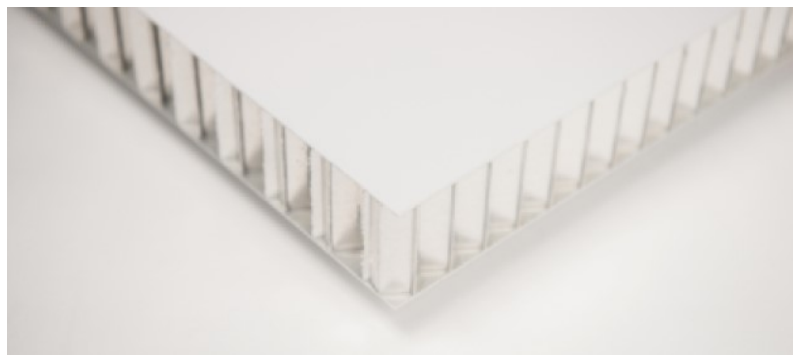

Benefits of choosing Plascore Modular Microelectronics Cleanroom System

Non-Progressive | Flexible | Easy Installation

Plascore is a vertically integrated cleanroom manufacturer that provides a complete line of cleanroom ceiling panels, walls, doors, windows as well as necessary trim. All components are designed to be both sturdy and lightweight for a robust cleanroom that is easily assembled. Our offerings include load bearing and non-load bearing ceiling panels; framed, studless, and liner walls; single and double doors; in addition to integrated window options.

- Non-progressive design allows any wall portion to be removed without disturbing the adjacent module.
- Wall systems share components allowing for an integrated design within a space.
- Pre-sized panels and posts minimizes custom cuts in the field.
- Post and Batten assembly can be cut together (one-cut solution).
- Unique mounting block connections allows for quick installation and reduces excess hardware.
- Panels can be manufactured up to 16'-1" for unbroken wall height. Higher wall design available with horizontal breaks.
- Static dissipative and non-static dissipative finishes available.
- All components are cleaned, packaged and ready for fast installation.
- The Plascore Cleanroom Sales Team is experienced in design, project management and customer service from the bid process through project completion.

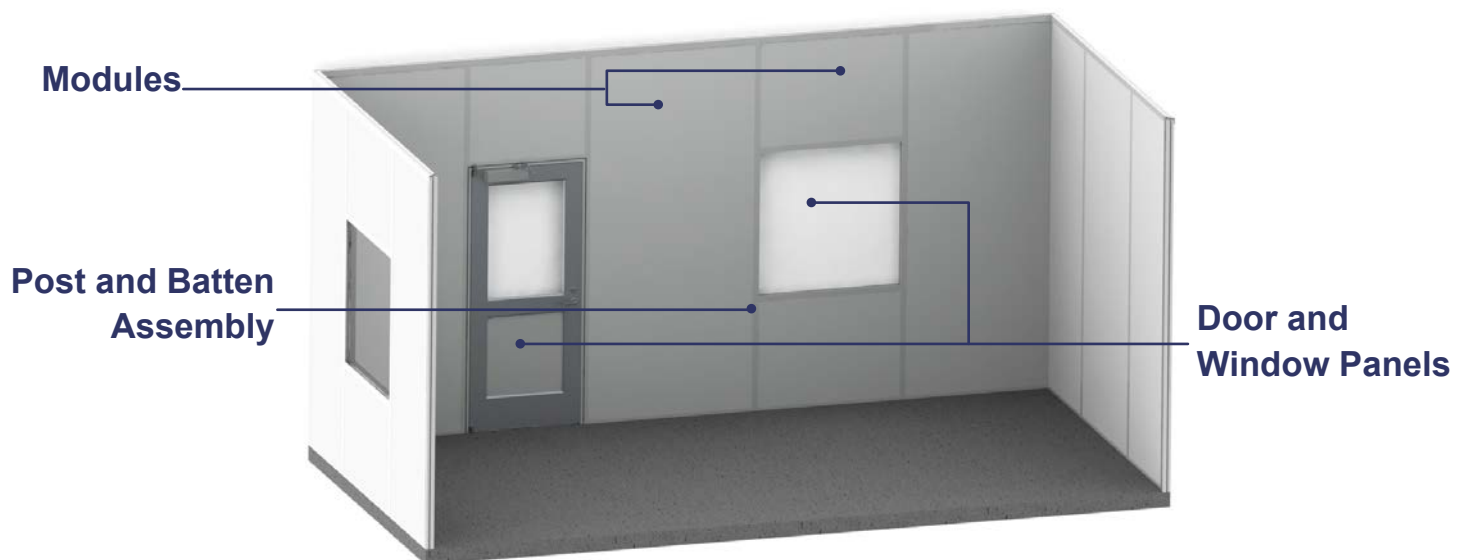

Micro Cleanroom Wall Systems

Plascore Micro Cleanroom wall systems were specifically engineered to allow interchangeability between the various systems allowing for fewer unique parts and greater flexibility when using multiple wall types. Changing from one wall type to another is as easy as switching out the post. Our Cleanroom Team can work with you to create unique design solutions as well.

F5075 Framed System

Single 2" Post (50 mm) and Double 3" Battens (75 mm)

The F5075 Framed wall system is Plascore's most versatile wall offering. This system allows panels to be removed from either the front or back of the wall and is compatible with both standard .25" and 2" aluminum honeycomb panels. Additional benefits of the F5075 Framed wall system include its ability to reach wall height greater than 16' without the need for lateral supports. The F5075 Framed wall is also custom configurable to achieve heights greater than 16'.

Double Batten Post

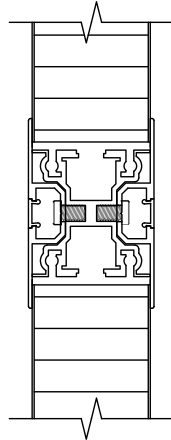

Single-Sided or Double-Sided Walls

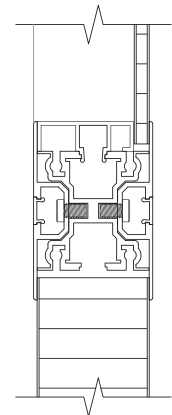

F2550 Framed System

Single 1" Post (25 mm) and Single 2" Battens (50 mm)

The F2550 Framed wall system was introduced to the market as an economical option for those customers who were looking for the quality of Plascore but didn't require a two-sided system. The F2550 single sided framed system allows for use of both .25" and 2" panels and shares many of the same components as other Plascore systems. Most common application is for walls 12' high or less, however it is also custom configurable to achieve higher wall heights.

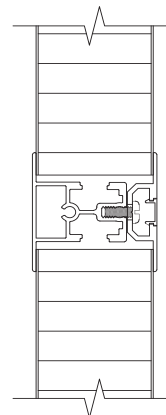

Framed Wall Components

Head Track

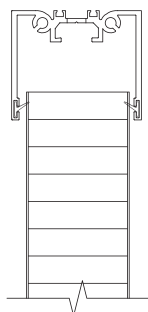

Floor Track

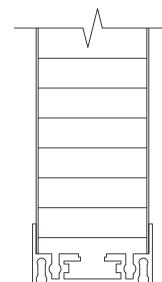

Corner Post

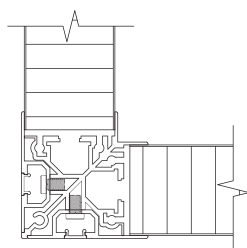

Glazing Clips

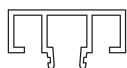

Double Glazing Clip
to hold (2) 1/4" panels
or glazing



Single Glazing Clip
to hold (1) 1/4" panel
or glazing

Mounting Blocks

Half



F5075

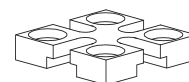

F2550



L2550 – Offset Liner System

Plascore has several options to cover existing walls or metal stud installations. Our popular L2550 Offset System is ideal for installation against existing walls and allows for rough, wavy, and imperfect base surfaces. It utilizes 1/4" panels and includes extrusions for all conditions.

Offset J-Trim

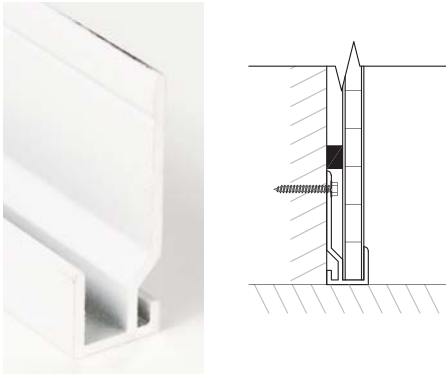

Trimmed Wing Batten

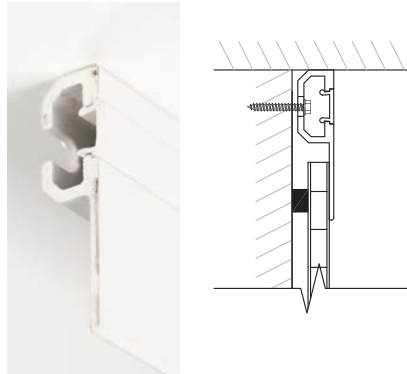

Vertical 2" Batten (3" also available)

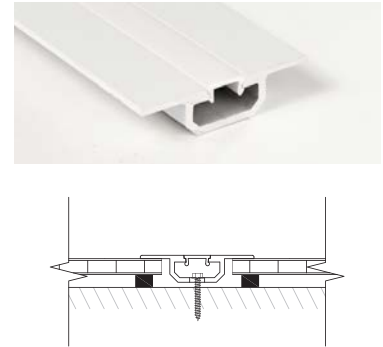

Offset Inside Corner

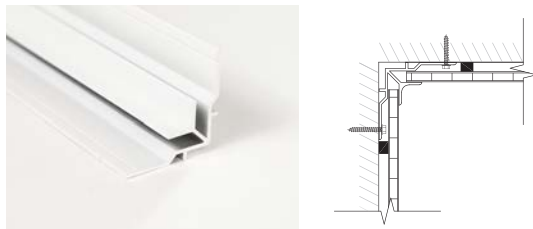

Offset Outside Corner

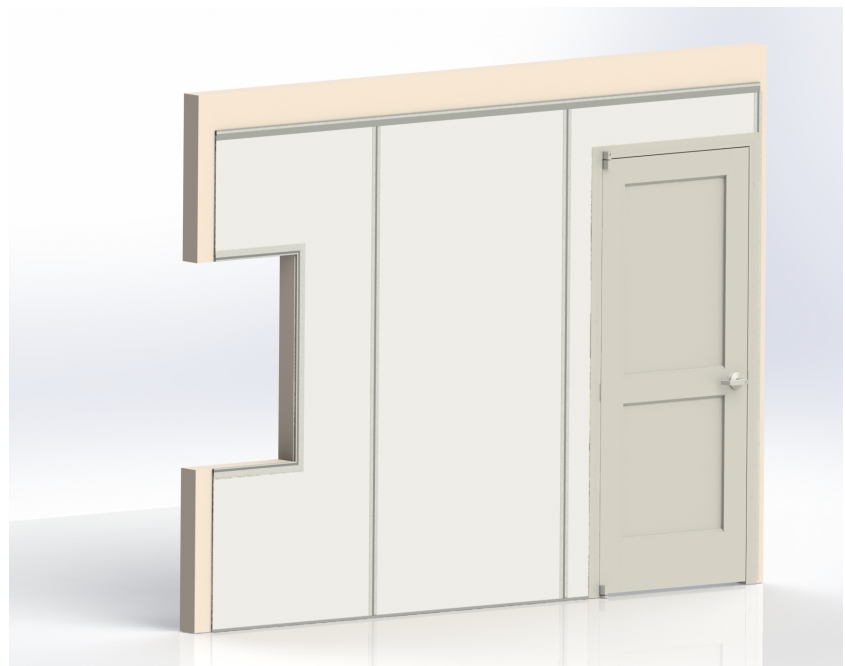
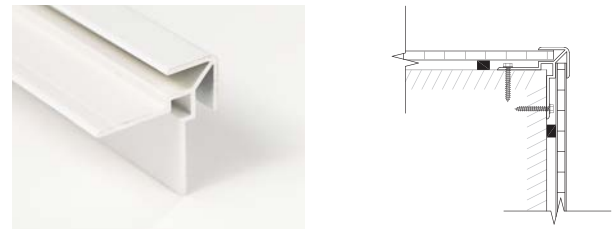

L2550 – Shallow Liner System

The L2550 Shallow Liner system uses 1/4" panels with two batten extrusions that address multiple design conditions. This simple and efficient system can be installed quickly with minimal components.

1.75" Shallow Batten

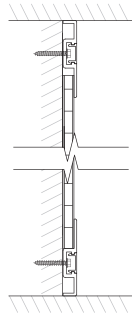

2" Shallow Batten

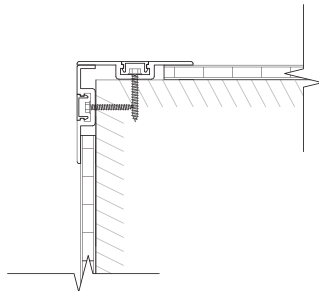
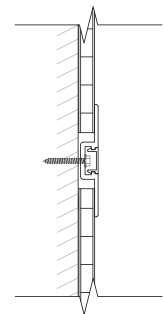

Inside and Outside
Corner configurations

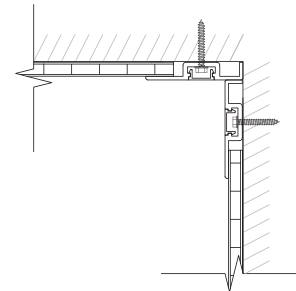

SL2550 2" Studless Wall

Batten-to-batten design eliminates the need for a post and can be used where walls do not require a horizontal. This system is compatible with both the F5075 and F2550 systems.

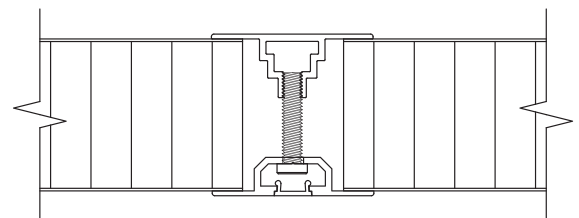

Additional Components for a Complete System

Cleanroom Doors

Plascore designs and manufactures doors in-house for a seamless installation. Door leafs and frames can have an anodized finish or can be powder-coated in a variety of colors. A selection of cost-effective standard hardware options is available or we can configure doors to a client's specification.

Door Types



- Single
- Double
- Transom
- No Glaze
- Half and Full Glazed
 - Tempered or Laminated
 - Vision panels also available in static dissipative acrylic or polycarbonate
- Standard leaf sizes with custom sizing available

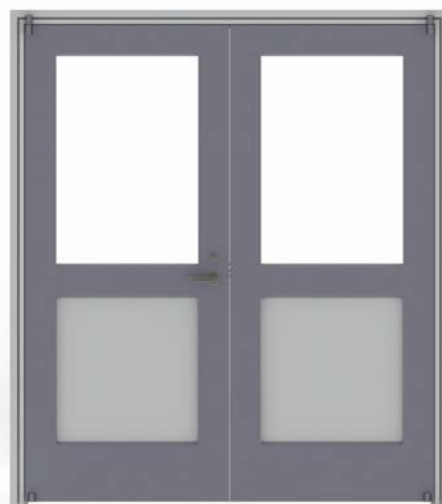

Door Hardware

- Push/Pull
- Lock Sets
- Exit Devices
- Internal or External Closers
- Automatic Door Sweeps
- Pivot and Hinge Options
- Position Switch
- Magnetic Locks
- Electrical Connection for Accessories
- Various hardware manufacturers and custom configurations available



Load-Bearing Ceiling Panels

Plascore's load-bearing cleanroom ceiling panels are strong and lightweight.

- Available with non-skid surfaces
- Thickness from 1" to 4". Contact Plascore for specific requirements
- Lightweight aluminum construction
- Bottom skin available in conductive or non-conductive finishes
- Cut to exact size to fit any grid
- Can be field cut if necessary
- Designs for Walkable ceiling grids available

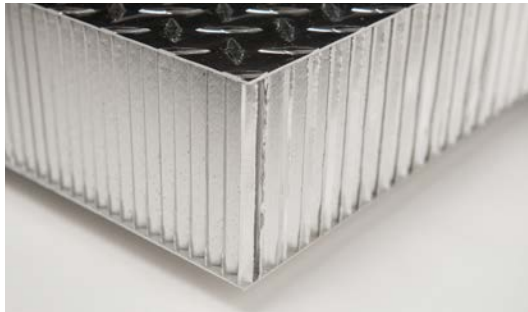

Non-Load-Bearing Ceiling Blanks

Plascore can design and produce ceiling blanks to meet the specifications of virtually any ceiling grid.

- Non-load-bearing
- Large range of thicknesses available
- Variety of color choices
- Conductive and Non-conductive finishes
- Lightweight aluminum construction
- Cut to exact size to fit any grid
- Can be field cut if necessary





Our Process

Plascore provides high quality components for Microelectronic Cleanroom construction. In addition, all teams throughout the process are committed to the highest standards focused on each customer's specific requirements. From quotation to product delivery and support through final inspection our goal is to make your project successful.

1. Sales & Design

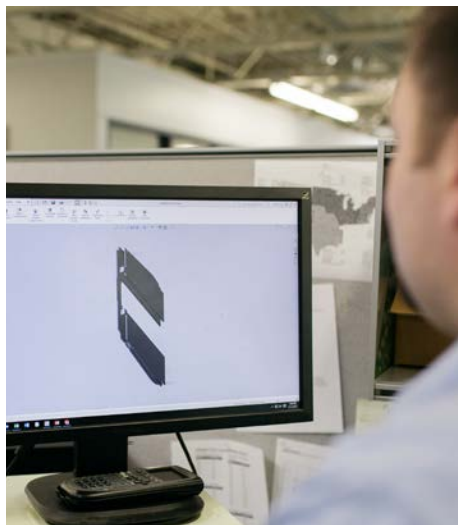

The Cleanroom Sales Team is your point of contact from bid process through project completion.

- Experienced Cleanroom Sales Service Team
- Project Manager assigned to each job for consistent and clear communication
- Components can be sized to job requirements
- Shop and door drawings available upon request
- Complete engineering support to assist with custom design solutions
- Superior service after the sale
- Product Sample Kits available

From raw materials to the smallest component our Purchasing Team provides consistent and cost-effective supply solutions.

- Established supply chains
- Comprehensive supply chain management to assure project success
- Suppliers who have been educated on the stringent requirements of the microelectronics industry

2. Purchasing / Procurement



3. Production

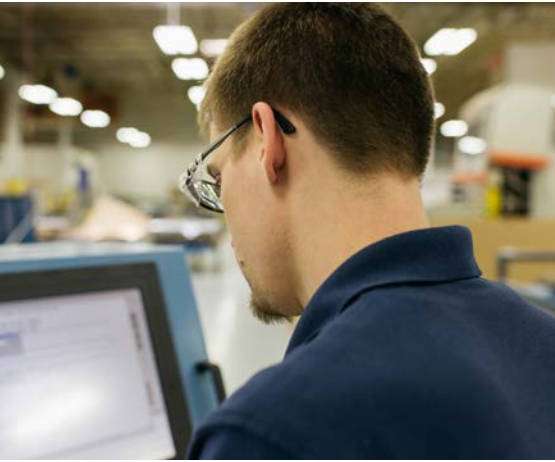

All components of Plascore's Cleanroom Systems are manufactured or assembled in our Zeeland, Michigan facilities.

- Panels are laminated and cut for individual projects
- Extrusions are painted, cut to length and packaged in cleanroom-approved packaging
- Our powder coat paint line provides for reduced lead-time and greater flexibility of color choices
- Specialized cleanroom doors are designed and built by an experienced production team using high quality hardware



4. Quality Control

Plascore's commitment to quality is followed through each step of the process. Quality Control works alongside our manufacturing group to ensure all material meets specifications.

Accreditations include:

- ISO 9001
- ISO 14001

5. Shipping



The Plascore Shipping Department is capable of handling any transport required to deliver product in a timely and cost-effective manner. Our staff is experienced with international and domestic shipments by LTL, dedicated truck, rail, container, or air. They can arrange your shipment or work with your preferred carrier.

- Internal dedicated shipping department
- Attention to unique requirements of construction site deliveries
- Assistance available to evaluate alternatives to minimize cost and meet delivery requirements

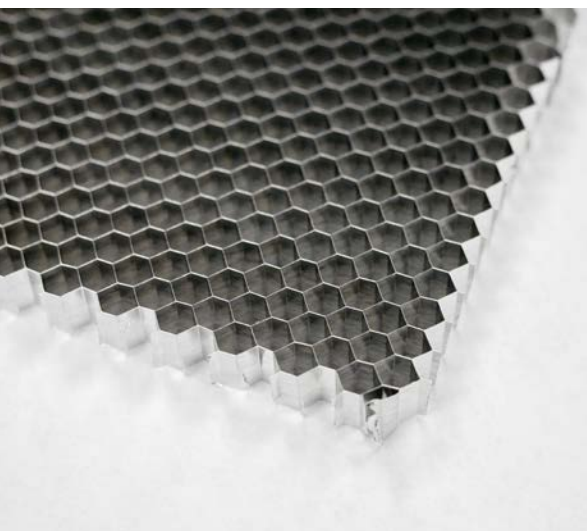

Corporate Headquarters

Plascore Incorporated

615 N. Fairview St.
Zeeland, MI 49464-0170

Phone: 616.772.1220
Toll-Free: 800.630.9257
Fax: 616.772.1289

plascore.com
sales@plascore.com

Europe

Plascore GmbH & CoKG

Feldborn 6
D-55444 Waldlaubersheim
Germany

Phone: +49(0) 6707.9143 0
Fax: +49(0) 6707.9143 40

plascore.de
sales.europe@plascore.com

Pharmaceutical Cleanroom Systems also available

Plascore, Inc. employs a quality management system that is AS/EN/JISQ 9100, ISO 9001:2015 and ISO 14001:2004 certified.

IMPORTANT NOTICE: The information contained in these materials regarding Plascore's products, processes, or equipment is intended to be up-to-date, accurate, and complete. However, Plascore cannot guarantee that this is always the case. Accordingly, it is a purchaser's or user's responsibility to perform sufficient testing and evaluation to determine the suitability of Plascore's products for a particular purpose. Information in these materials and product specifications does not constitute an offer to sell. Your submission of an order to Plascore constitutes an offer to purchase which, if accepted by Plascore, shall be subject to Plascore's terms and conditions of sale. PLASCORE MAKES NO WARRANTIES OF ANY KIND REGARDING THESE MATERIALS OR INFORMATION, EITHER EXPRESS OR IMPLIED, INCLUDING WITHOUT LIMITATION THE IMPLIED WARRANTIES OF MERCHANTABILITY AND FITNESS FOR A PARTICULAR PURPOSE. Plascore owns and shall retain all worldwide rights in its intellectual property, and any other trademarks used in these materials are the property of their respective owners. The information in these materials shall not be construed as an inducement, permission, or recommendation to infringe any patent or other intellectual property rights of any third parties. 2023 Plascore, Inc. All Rights Reserved. v04.01.23